



COMPANY
MANAGEMENT SYSTEM
CERTIFIED BY DNV GL

= ISO 9001 =
= ISO 14001 =



MID MI-001

Single-jet water meter
with dry dial counter

ALLEFA SDOO

ALFA SDC

Single-jet water meter with dry dial counter

PERFORMANCE ACCORDING TO MID 2014/32/UE DIRECTIVE * AS AMENDED

SIZE		PERMANENT FLOW	MAXIMUM FLOW	TRANSITIONAL FLOW	MINIMUM FLOW	WORKING PRESSURE	MINIMUM READING	MAXIMUM READING	TEMPERATURE CLASS
(mm)	(inch)	Q ₃ (m ³ /h)	Q ₄ (m ³ /h)	Q ₂ (L/h)	Q ₁ (L/h)	(bar)	(l)	(m ³)	
13/15	1/2"	2,5	3,125	50	31,3	16	0,05	99.999	T30/T50
20	3/4"	4,0	5,000	80	50,0	16	0,05	99.999	T30/T50
25	1"	6,3	7,875	126	78,8	16	0,05	99.999	T30/T50
30	1 1/4"	10,0	12,500	200	125,0	16	0,05	99.999	T30/T50
40	1 1/2"	16,0	20,000	320	200,0	16	0,05	99.999	T30/T50

* It replaces the MID 2004/22/CE Directive.

Metrological class MID (Q₃/Q₁) R = 80

Rev. 4/2017 The content of this data sheet is intended to give general information only, we reserve the right to make alterations without prior notification



TYPICAL ERROR CURVE

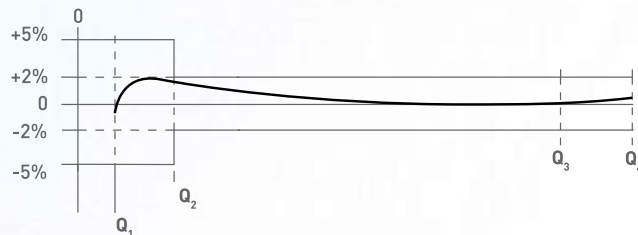

PRESSURE LOSS DIAGRAM

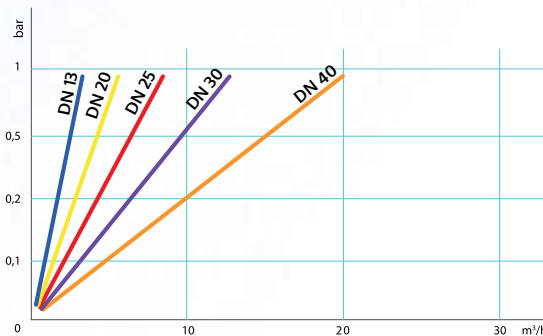

DIMENSIONS

(mm) SIZE (inch)	13/15	20	25	30	40
L (mm)	80 - 110 115 - 120	115 - 130	160	160	200
H (mm)	85	85	106	106	123
TOTAL LENGTH OF CONNECTORS (mm)	80	100	100	120	140

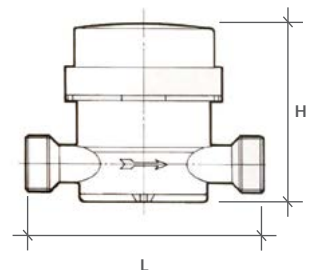

For additional information and options, do not hesitate to contact us

WATERTECH S.P.A. - Water meters

Factory, commercial main office and administration: Str. Antica Fornace, 2/4 • 14053 Canelli (AT) – Italy
Tel +39 0141 822106-832151 • **Fax** +39 0141 832191-832198 • **Mail** info@wtmeters.it • **Web** www.wtmeters.it