



COMPANY
MANAGEMENT SYSTEM
CERTIFIED BY DNV GL
= ISO 9001 =
= ISO 14001 =



MID MI-001

Volumetric rotary piston
water meter dry dial

GAMMA SDC

GAMMA SDC

Volumetric rotary piston water meter dry dial

PERFORMANCE ACCORDING TO MID 2014/32/UE DIRECTIVE * AS AMENDED

SIZE		PERMANENT FLOW	MAXIMUM FLOW	TRANSITIONAL FLOW	MINIMUM FLOW	WORKING PRESSURE	MINIMUM READING	MAXIMUM READING	TEMPERATURE CLASS
(mm)	(inch)	Q_3 (m ³ /h)	Q_4 (m ³ /h)	Q_2 (L/h)	Q_1 (L/h)	(bar)	(l)	(m ³)	
13/15	1/2"	2,5	3,125	25,0	15,6	16	0,05	99.999	T30/T50
20	3/4"	4,0	5,000	40,0	25,0	16	0,05	99.999	T30/T50
25	1"	6,3	7,875	63,0	39,4	16	0,05	99.999	T30/T50

* It replaces the MID 2004/22/CE Directive.

Metrological class MID (Q_3/Q_1) R \geq 160

TYPICAL ERROR CURVE

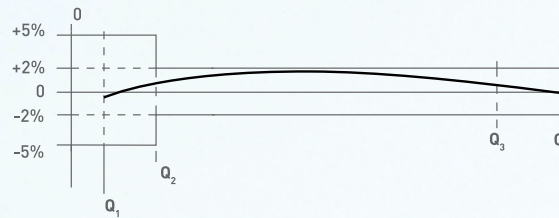

PRESSURE LOSS DIAGRAM

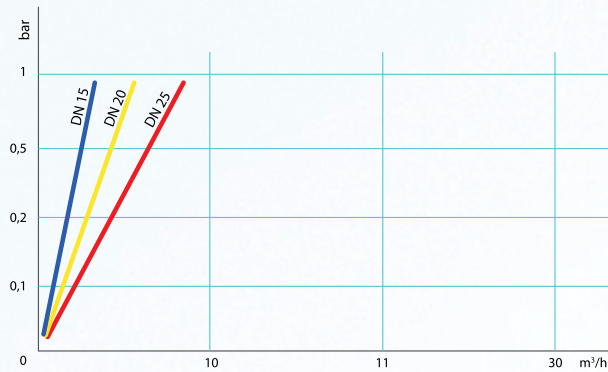

DIMENSIONS

(mm) SIZE (inch)	13/15	20	25
L (mm)	110-145 165-170	190	260
H (mm)	112	125	145
TOTAL LENGTH OF CONNECTORS (mm)	80	100	100

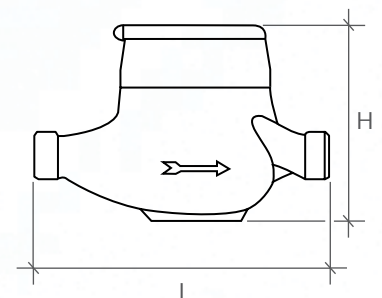

Rev. 4/2017 The content of this data sheet is intended to give general information only, we reserve the right to make alterations without prior notification



For additional information and options, do not hesitate to contact us

WATERTECH S.P.A. - Water meters

Factory, commercial main office and administration: Str. Antica Fornace, 2/4 • 14053 Canelli (AT) – Italy
Tel +39 0141 822106-832151 • **Fax** +39 0141 832191-832198 • **Mail** info@wtmeters.it • **Web** www.wtmeters.it